

Waterproofing and Anti-Fracture Reinforcing Fabric



1. Product Name

Waterproofing and Anti-Fracture Reinforcing Fabric

2. Product Description

An alkali-resistant fiberglass fabric used to reinforce RedGard®, Custom® 9240, FractureFree®, CBP-232, and RedGard® SpeedCoat® when used over cracks in underlayment. It can also be used in corners and wherever there is a change of plane in the installation for additional reinforcement.

Key Features

- Helps prevent cracks in tile and breaks in waterproofing
- Reinforces liquid-applied membranes when used over cracks or changes of plane in underlayment

Suitable Substrates

- Concrete, cement mortar, masonry
- Cement Backerboard
- Exterior Plywood and OSB (interior, dry areas only)
- Exterior Decks - Contact Technical Services
- Post-Tension Concrete - Contact Technical Services
- Lightweight Concrete (min. 2000 psi compressive strength)
- Gypsum-Based cement topping (min. 2000 psi compressive strength)
- Existing ceramic tile and resilient flooring

Composition of Product

Non-woven fiberglass fabric with an alkali-resistant coating.

Benefits of Product in the Installation

Helps prevent cracks occurring in the tile or breaks in the waterproofing and crack isolation treatments in areas with expected higher degree of movement such as changes of plane.

3. Technical Data

Applicable Standards

No industry standards are available for tape alone.

Technical Chart

- Non-woven fiberglass fabric
- Alkali-resistant coating

Environmental Consideration

Custom® Building Products is committed to environmental responsibility in both products produced and in manufacturing practices.

4. Instructions

General Surface Prep

Exterior and wet areas must have proper sloping to drains. All surfaces must be structurally sound, clean, dry and free from contaminants that would prevent a good bond. Newly prepared concrete must be troweled smooth and textured to a fine broom finish and cured for 28 days. Existing surfaces must be scarified and leveled, and all defects must be repaired. Cracks exceeding 1/8" (3 mm) should be treated in accordance with TCNA F125 or TCNA F125A.

Movement Joint Placement

Do not bridge joints designed to experience movement with tile, adhesives, or surface preparation materials. When waterproofing areas with expansion joints, loop fabric into joint as shown below:

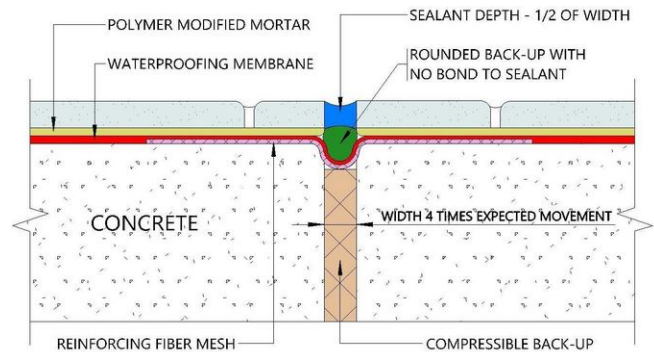

Substitute an open or closed cell-backer rod in the concrete joint under the looped fabric and compressible back-up is not utilized.

Apply liquid waterproofing into the fabric in a thickness consistent with the concrete surface area in two coats. Do not apply too thick and allow first coat to dry prior to second coat. After the tile work is properly set, follow ASTM C1193 to fill the joint with a specified color sealant.

Fabric is not required over movement joints when applying liquid solely for crack isolation

Application of Product

Follow installation instructions provided with RedGard®, Custom® 9240, FractureFree®, CBP-232, or RedGard® SpeedCoat®

Cleaning of Equipment

Clean tools and hands with water before the material dries.

Health Precautions

Wear impervious gloves and eye protection while using this product. Avoid contact with eyes or prolonged contact with skin. Wash thoroughly after handling. If eye contact occurs, rinse cautiously with water for several minutes, remove contact lenses if easy to do: continue rinsing. Immediately seek medical advice if symptoms are significant or persist. Do not take internally. KEEP OUT OF REACH OF CHILDREN.

Conformance to Building Codes

Installation must comply with the requirements of all applicable local, state and federal code jurisdictions.

5. Size & Availability

Waterproofing and Anti-Fracture Reinforcing Fabric

Item Code	Size	Package
WPRF6	6" x 75'	Roll

6. Product Warranty

Custom® Building Products warrants to the original consumer/purchaser that its product shall be free from defects in material and workmanship under normal and proper usage for a period of one year following the date of original purchase. Custom's® sole liability under this warranty shall be limited to the replacement of the product. Some states, countries or territories do not allow the exclusion or limitation of incidental or consequential damages, so the above limitation or exclusion may not apply to you. This warranty will not extend to any product which has been modified in any way or which has not been used in accordance with Custom's® printed instructions. Custom® makes no other warranties either expressed or implied. This warranty gives you specific legal rights, and you may have other rights that vary from state to state or from one country/territory to another. For details and complete warranty information, visit custombuildingproducts.com/reference-library/warranties.aspx

7. Product Maintenance

Properly installed product requires no special maintenance.

8. Technical Services Information

For technical assistance, contact Custom® Building Products.

9. Filing System

Additional product information is available from the manufacturer upon request.
